

Notes:
 1. To be used with CDM Risk Register
 2. Do not scale, check this is the latest version, if in doubt, ask see drawing blue for latest history.

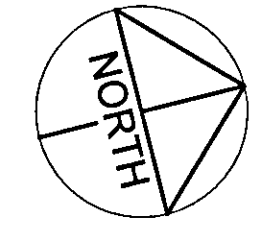

NOTE:
 1. All public realm/landscaping shown for indicative purposes only.
 2. All internal layouts shown for indicative purposes only.

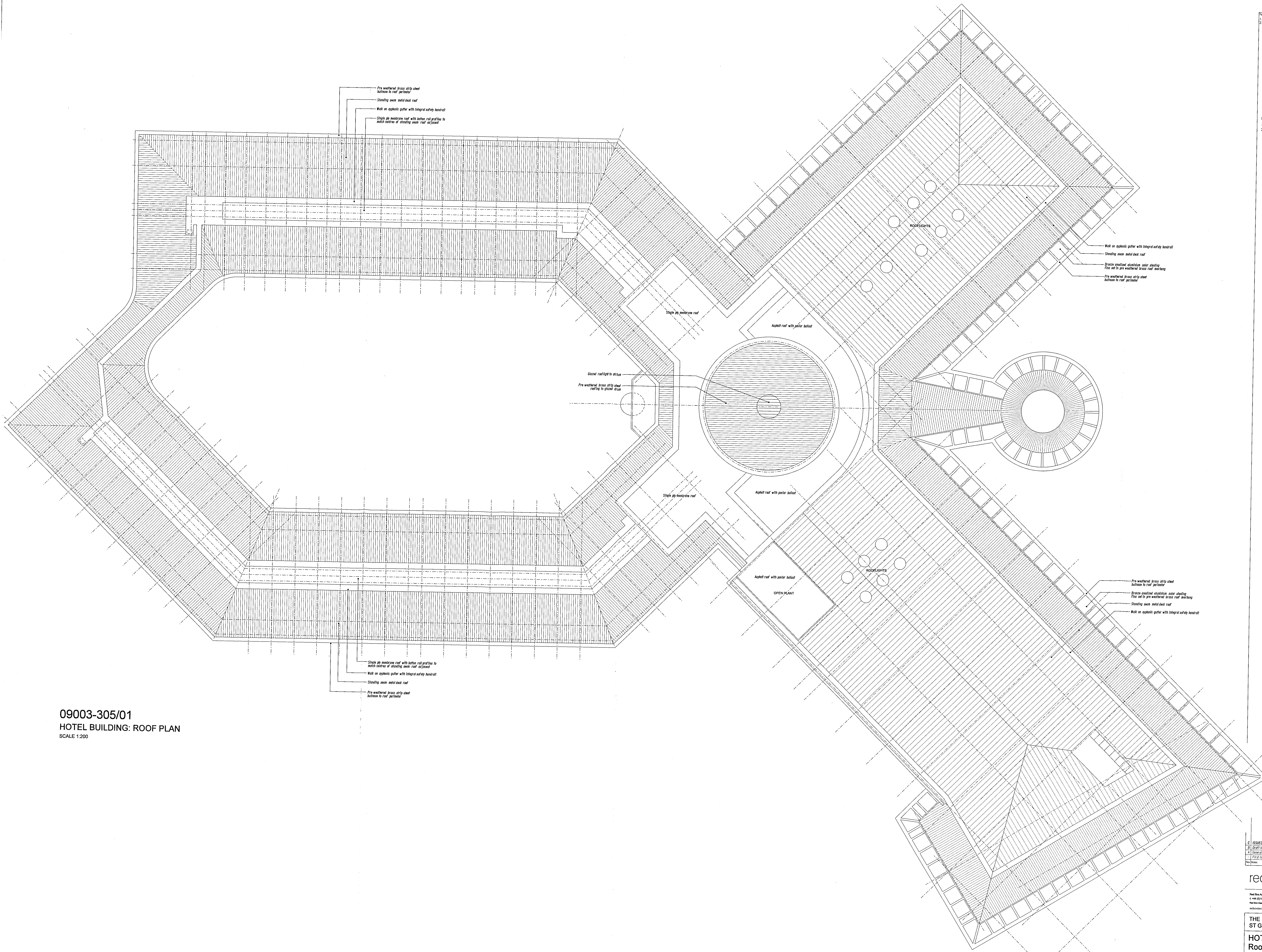

Pre weathered brass strip sheet
 bolted to roof perimeter
 Standing seam metal deck roof
 Walk on synthetic gutter with integral safety handrail
 Slope ply membrane roof with battens and rafters to
 match contours of standing seam roof adjacent

Walk on synthetic gutter with integral safety handrail
 Standing seam metal deck roof
 Drainage channel aluminium outer sloping
 this set to pre weathered brass roof covering
 Pre weathered brass strip sheet
 bolted to roof perimeter

Glazed rooftop to office
 Pre weathered brass strip sheet
 bolted to roof perimeter

Pre weathered brass strip sheet
 bolted to roof perimeter
 Drainage channel aluminium outer sloping
 this set to pre weathered brass roof covering
 Standing seam metal deck roof
 Walk on synthetic gutter with integral safety handrail

Slope ply membrane roof with battens and rafters to
 match contours of standing seam roof adjacent
 Walk on synthetic gutter with integral safety handrail
 Standing seam metal deck roof
 Pre weathered brass strip sheet
 bolted to roof perimeter

09003-305/01
 HOTEL BUILDING: ROOF PLAN
 SCALE 1:200

RECEIVED
 24 FEB 2010
 TIME:

P/10/00255

C ISSUED FOR PLANNING	20/02/10	AC	SP
B Draft Issue For Comments	20/02/10	AC	SP
A General Update	20/02/10	RY	SP
1 First Issue	20/02/10	RY	SP
Pre Name	Date	By	Drawn

redboxarchitecture

Red Box Architecture, St Nicholas Church, Newcastle upon Tyne, NE1 1RU
 T +44 (0)191 245 2700, F +44 (0)191 245 2711, mail@redboxdesign.com, www.redboxdesign.com
 Red Box Group: redboxdesign.com, www.redboxdesign.com
 redboxdesigngroup - redboxdesign - redboxdesign

**THE NATIONAL FOOTBALL CENTRE
 ST GEORGE'S PARK**

**HOTEL BUILDING
 Roof GA Plan**

1:200	09 003	305	C
A0	PLANNING		

Copyright © Red Box Design Group Ltd 2010